

A man and a woman are in a bar or restaurant setting. The man is standing and holding a glass, while the woman is sitting at a bar counter, also holding a glass. They are both smiling and looking at each other. The background features large windows, a tufted leather booth, and a bar counter with various glasses and bottles. The lighting is warm and ambient, with several pendant lights hanging from the ceiling. A semi-transparent white diagonal overlay covers the left side of the image, containing the text and switch images.

Radium



**Bluetooth Control
Wall Switch**
User manual

The battery-less, energy harvesting, Bluetooth Low Energy switch modules can be paired to a Casambi network.

The switches can control individual luminaires, groups of luminaires, all luminaires in a network, scenes and animations.

! Please note: The switches can be used and configured in a Casambi control system with both Android and iOS devices, however the switch can only be paired to a Casambi network with an Android device at this stage. If and when Apple opens an API, we will naturally implement the functionality to pair the Bluetooth Control Wall switches to Casambi networks with iOS devices as well.

Wall switches are added to the Casambi network in the following manner:

1. Go to More > Switches in your Android device
2. Click on "Add a Dolphin Switch"
3. Touch the switch with the back side of your mobile device, when NFC is activated.

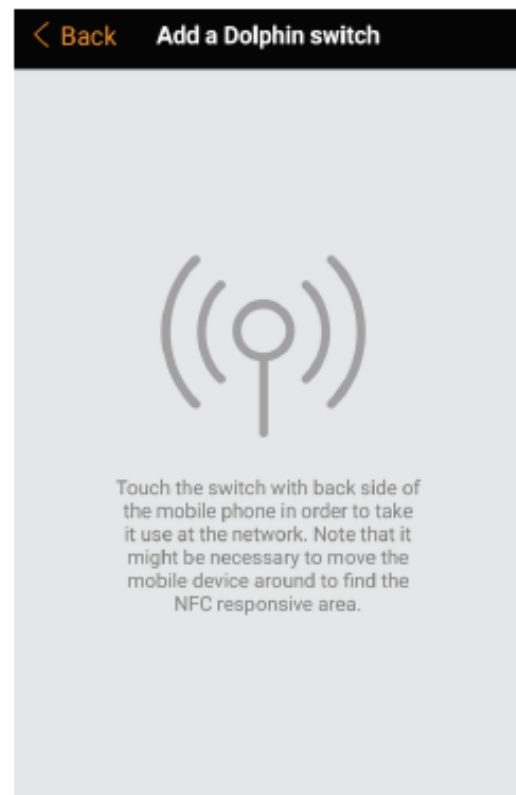
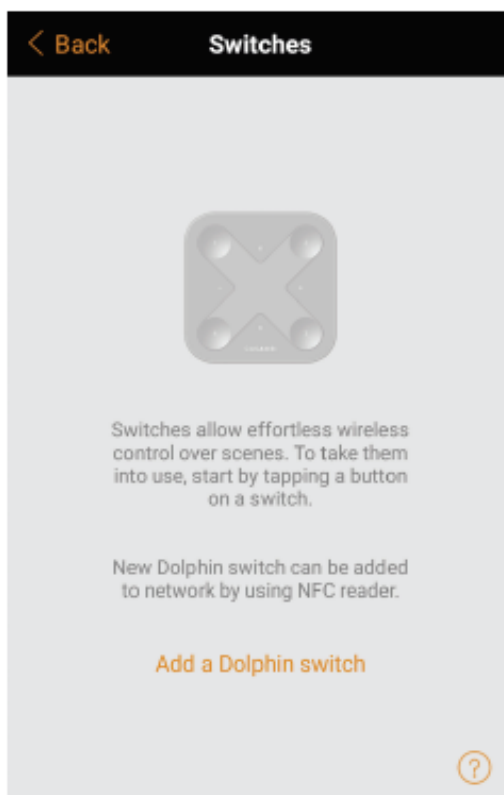

4. When the NFC reader of your mobile device detects the Dolphin switch you will hear a noise and switch list page is opened with the added Dolphin switch.

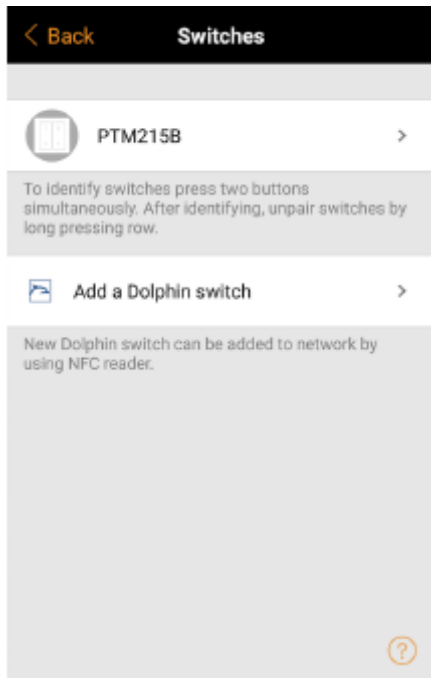

5. When you click on the switch a configuration page for the switch is opened. Here you can configure the functionality of your switch, change the name and the faceplate. Please make sure you have the correct faceplate before you start configuring.

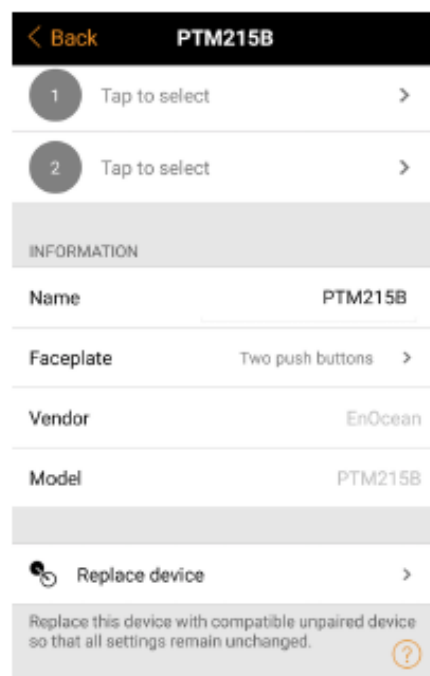
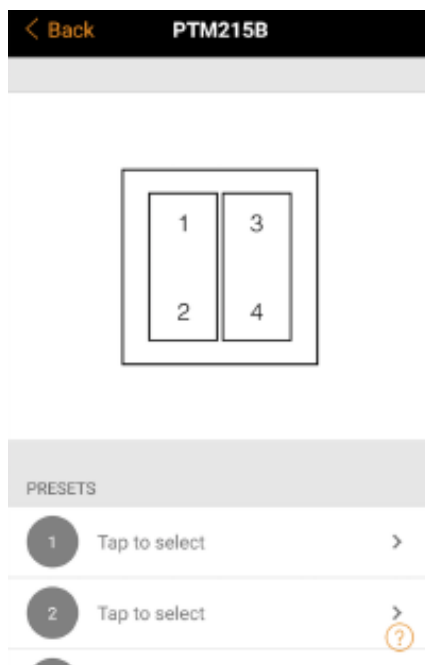

6. By clicking on the faceplate picture (as a default the Casambi app will show the 4 button faceplate) you will be directed to a list of all possible faceplate options. Choose the one to match your Dolphin switch. The scope of delivery contains single- and double rocker. The faceplate in the app which are marked with + or – symbol are designated for dimming up and down. You can also control the colourtemperature of a tunable white luminaire by the lower faceplate.

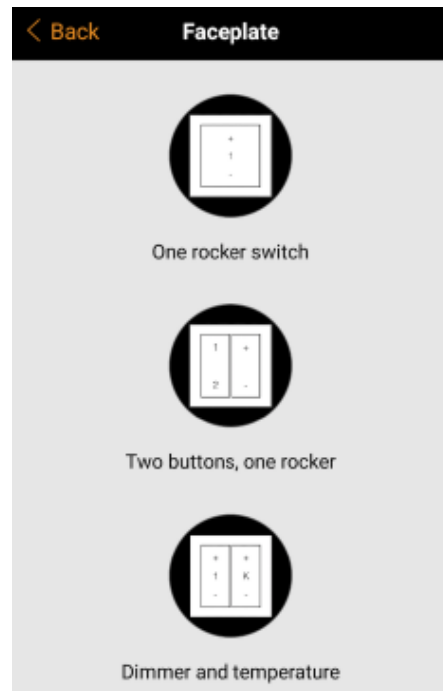
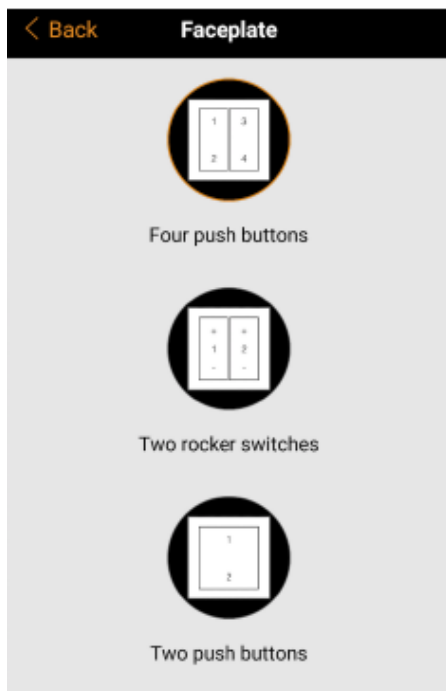

7. Now you can choose the luminaire, luminaire-group or scene, which should be controllable, by tipping on > in pre-settings.

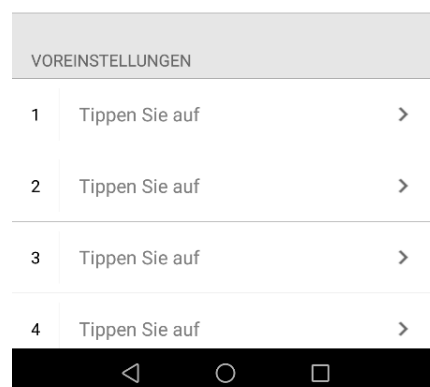
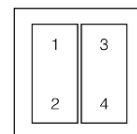

Handling

The handling of the luminaires with the switch varies depending on the facetape. Generally the deposited scene can be switched on and off by short tipping on the facetape and can be dimmed by long tipping.